



The Nobi Ceiling Light is an AI-powered, ceiling-mounted device purpose-built to safeguard elderly individuals and people with physical or cognitive impairments. More than just a light, it acts as a proactive care system offering 24/7 monitoring, fall detection, emergency alerting, and preventive insights, all in one sleek unit.

Product name	Nobi Ceiling Light 2.1
Model number (SKU)	144016

User experience

Environment	Indoor dry location (living room, bedroom...)
--------------------	---

Install instructions

Scan this QR code for step by step instructions



Physical characteristics

Weight	Nobi Ceiling Light 2.1: 9.04 lbs / 4,1 kg Nobi Power 2.1: 0.88 lbs / 0,4 kg
Color	<input checked="" type="checkbox"/> Desert PANTONE 13-4403 TPG
IP rating	IP20
Operating temperature	50 °F to 104 °F / 10 °C to 40 °C

Dimensions

(Coverage area: 26 ft / 7,9 m)

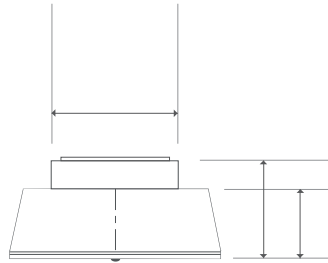

Ceiling adapter (optional):
h 0.41 in / 10,5 mm
Ø 6.63 in / 168,4 mm

Ø 8,9 in / 226 mm
h 7,55 in / 191,7 mm
h 5.39 in / 136,8 mm

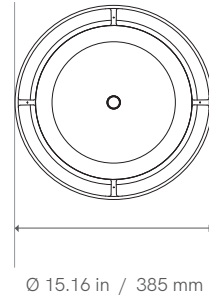

Light specifications

Color temperature	LED light (2700 - 6500 K)
Brightness	2,377 lm
Luminous efficacy	68.1 lm/W
Color rendering index	96

Luminous intensity distribution

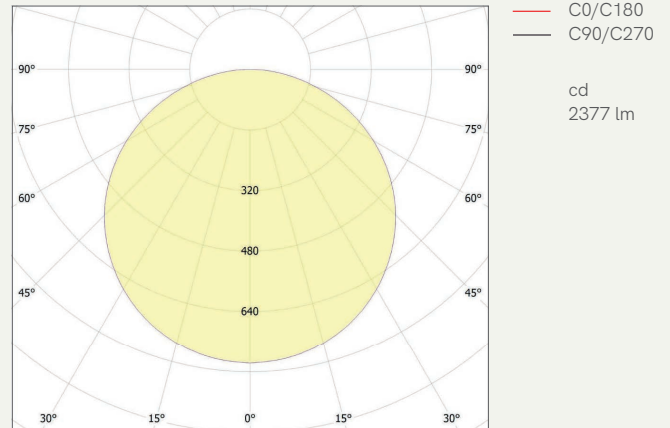

Technical specifications

Operating voltage	100/240 V AC (50/60 Hz)
Power consumption	Standby: 18 W Normal: 52 W
Maximum Load	Nobi Power 2.1: 80 W

Order information

Content	Box A	Nobi Ceiling Light 2.1
	Box B	Nobi Power 2.1 Ceiling Adapter 4 metric screws

Connectivity & compatibility

Bluetooth	BLE 5.0
WIFI	802.11 a/b/g/n/ac
Compatibility	iOS and Android

EAN code 5407011440163

Contact
Nobi USA Inc.
820 Gessner Road
Suite 120, Houston
TX 77024, US

Nobi NV
Generaal Lemanstraat 47
2018 Antwerp, BE

Environment & safety

Warranty 2 years

Certifications FCC ID N6C-SXPCEAC2 R-41268240

Recycling