



Badge Installation & Onboarding Manual



Thank you for choosing **Nobi**

This document provides the key information needed to assign and manage Badges using the Nobi Mobile App.

For step-by-step guidance on assigning a Nobi Badge, visit:
<https://tinyurl.com/449ymeu3>



Table of contents

| | |
|------------------------------|---|
| Preparation | 3 |
| Pairing the Nobi Badge | 4 |
| Warnings | 6 |

Contact Nobi



General questions

Take a look at our frequently asked questions and answers:
nobi.life/frequently-asked-questions



Support

For technical support during installation, contact Nobi Support: support@nobi.life

Preparation

Contents:

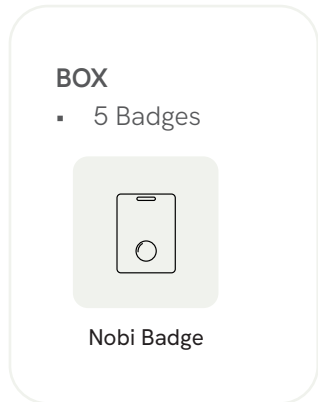

Required Tools (not included):

- PC or Mac (if signing in via the Badge is not required)
- Mobile device with NFC enabled (if signing in via Badge is required)

Estimated time:

- Onboarding — 10 minutes

Before you begin:

- Ensure Nobli Lights are installed and onboarded.
- A user account has been created to assign the Badge to.
- Mobile devices are authorized for Badge sign-in.*

* This is done by logging in as a manager on that specific mobile device before starting the onboarding of this Nobli Badge.

Pairing the Nobi Badge



Before you begin the onboarding process:

1. **Contact your local distributor or Nobi before onboarding,** as your account must be created first.
2. **Download the app:**

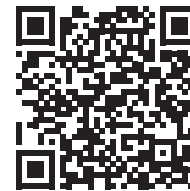

Pairing the Nobli Badge

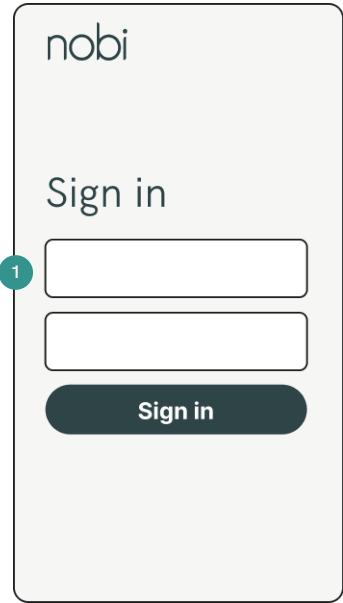

1 Sign in to the Nobli Mobile App as a **manager** on an authorized mobile device.



2 Tap the new Badge to the back of the mobile device.

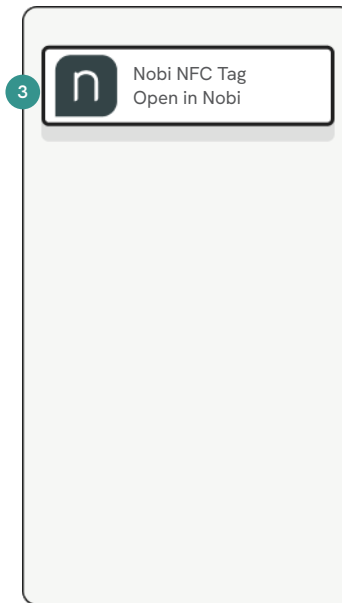

3 Click on the notification that appears (iOS only).

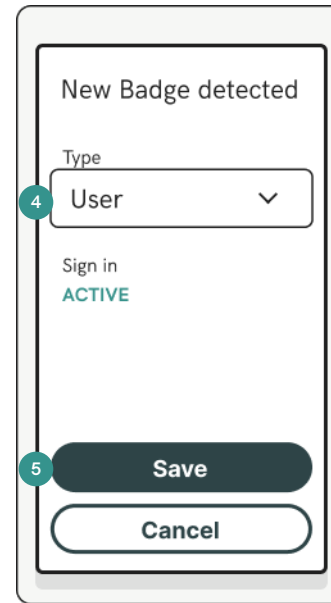

4 "New Badge detected" will pop up.
Select the user from the dropdown menu that you want to assign the Badge to.

5 Save this selection.

The Badge is now assigned to the user.

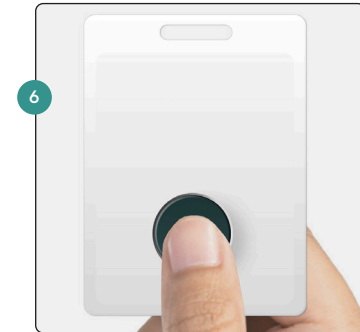

6 To enable a new Badge for the first time, **press and hold the button for 3 seconds** to activate the battery.

Warnings for the Badge

Environmental conditions

- Operating temperature: -4 °F to 140 °F (-20 °C to 60 °C)
- Transmission range: up to 360.9 ft (110 m) without obstacles
- IP rating: IP 66

Technical specifications

- Battery: CR3032 (replaceable)

Certifications

- CE
- FCC (ID: D2AO94-H5PRO)
- RoHS

Disposal message

Your product is designed and manufactured with high quality materials and components, which can be recycled and reused. Please find out for yourself about the local separate collection system for electrical and electronic products. Please act according to your local rules and do not dispose of your old products with your normal Household waste. The correct disposal of your old product will help prevent potential negative consequences for the environment and human health.